

100YR ELEVATION = 482.00
 REQUIRED FINISHED FLOOR ELEVATION = 483.00
 GROUND ELEVATION = 468.75
 REQUIRED BUILDING RAISE = 14.25 FT

REQUIRED ADA RAMP LENGTH AT 8.33% WITH LANDING = 180.00 FT
 THIS WILL REQUIRE 6 LANDINGS

USING A FILL SLOPE WITH A 3H:1V SIDE SLOPE ~ THIS IS A MINIMUM
 FOOT PRINT OF 130.00 FT BY 103.00 FT.

2016_Klondike Park_VARIANCE Exhibit

2/25/22

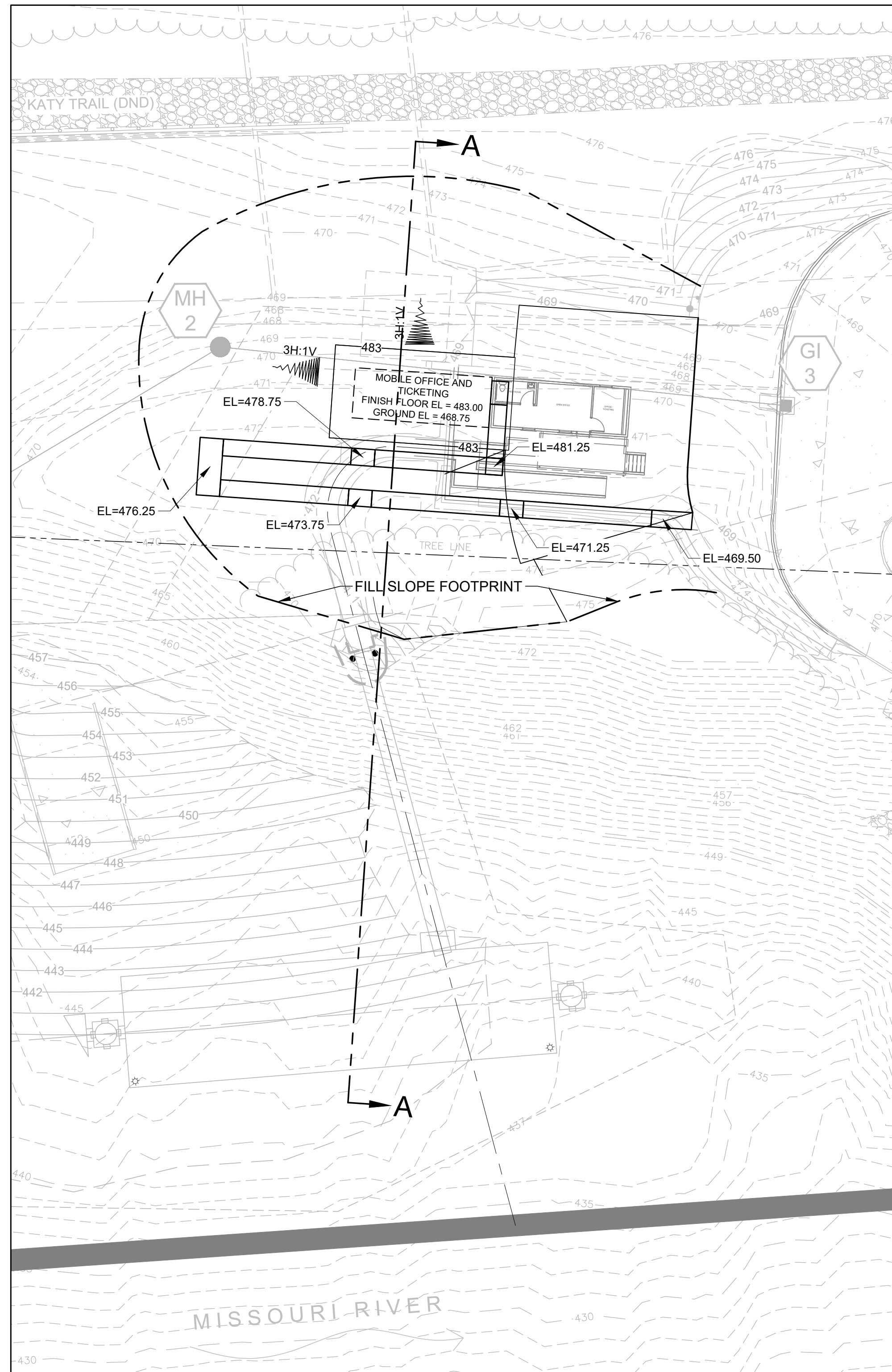

**ALTERNATIVE LAYOUT
 GRADE RAISE TO ELEVATE STRUCTURE**

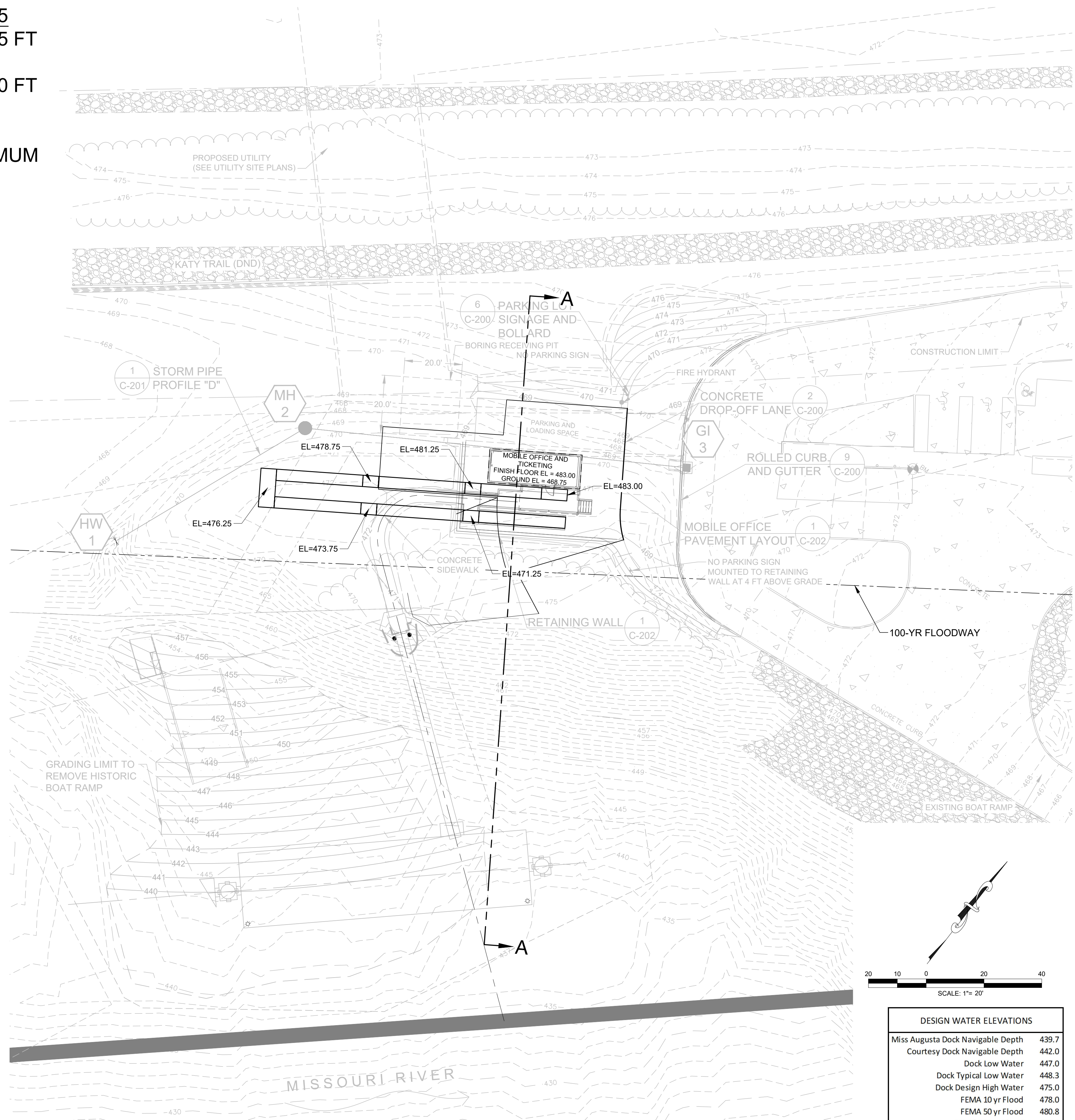

ELEVATED STRUCTURE ON PIERS

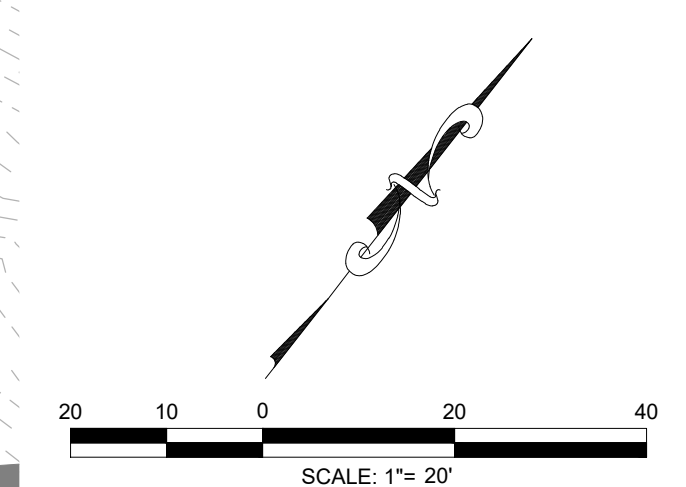

DESIGN WATER ELEVATIONS	
Miss Augusta Dock Navigable Depth	439.7
Courtesy Dock Navigable Depth	442.0
Dock Low Water	447.0
Dock Typical Low Water	448.3
Dock Design High Water	475.0
FEMA 10 yr Flood	478.0
FEMA 50 yr Flood	480.8
FEMA 100 yr Flood	482.0
FEMA 500 yr Flood	484.3
1993 Flood of Record	483.4



INTUITION LOGIC
 Intuition & Logic Engineering, Inc.
 MO Certificate of Authority
 # 2000152987
 16253 Swingle Ridge Rd.
 Suite 100
 Chesterfield, MO 63017
 Phone (636) 777-3000
 Fax (636) 432-5812

Ross & Baruzzini
 6 SOUTH OLD ORCHARD AVE.
 ST. LOUIS, MO 63119
 T: 314.918.8383
 F: 314.918.1966
 www.rossbar.com
 MISSOURI STATE CERTIFICATE
 OF AUTHORITY #000148

kpff
 1630 DES PERES ROAD,
 SUITE 100
 ST. LOUIS, MO 63131
 T: 314.835.0524
 F: 314.835.0749

**KLONDIKE PARK MISS AUGUSTA
 CRUISE DOCK PHASE 1 PROJECT**
 Saint Charles County, Missouri

THE PROFESSIONAL WHOSE SIGNATURE AND PERSONAL SEAL APPEAR ON THIS PAGE, AND DISCLOSED IN ACCORDANCE WITH SECTION 320.011, ASSUMES RESPONSIBILITY FOR ALL DESIGN, PLANS, SPECIFICATIONS, AND INSTRUMENTS NOT SEALED BY THE UNDERSIGNED PROFESSIONAL RELATING TO THE PROJECT TO WHICH THIS PAGE REFERS.

Professional Engineer Seal
 Timothy Patrick Dean - Engineer
 MO# E-2008019536

**PRELIMINARY
 NOT FOR
 CONSTRUCTION**

Expiration Date: DEC. 31, 2022

Rev	Date	Description
-	-	-
-	-	-
-	-	-
-	-	-

Date: JUL. 16, 2021
 Drawn by: JDF
 Checked by: MSA
 Approved by: TPD

PROJECT NO. 2016

SHEET TITLE:
**VARIANCE
 EXHIBIT**

SHEET NUMBER:
EX-1

Path: P:\2016 - ST. CHARLES CO - Klondike Park Boat Dock\CAD\Exhibits
 Plotted on: 2/25/22 @ 1:24:33 PM by FINGERHUT