

This road project paid in part through the  
St. Charles County ½ Cent Transportation Sales Tax.

## **INTERSTATE DRIVE PHASE 2**

### **Project Location:**

Interstate Drive from Quail Ridge Parkway to Route Z

### **Project Description:**

This project provided for an extension of Interstate Drive east of Route Z to connect to the existing I-64 Eastbound Outer Road that terminated at Quail Ridge Parkway, the entrance to Quail Ridge Park. This new segment of Interstate Drive was constructed with two 12-foot concrete lanes and 6-foot shoulders. A new 10-foot-wide asphalt multi-use path was constructed along the south side of the road. Left-turn lanes were provided at the intersections of Interstate Drive with Route Z and Quail Ridge Parkway.

**Project Status:** Construction completed

**Original Anticipated Project Cost:** \$3,034,130

**FINAL PROJECT TOTAL (Funded 100% by County):** \$3,239,487

**Completion Year:** 2015

**Contact:** County Highway

**Phone:** 636-949-7305

**Email:** [highway@sccmo.org](mailto:highway@sccmo.org)

**Website:** [County Highway Department](#)

[St. Charles County Public Web Map Link](#)

Update: 10/25/2023

# SAINT CHARLES COUNTY

## INTERSTATE DRIVE, PHASE II

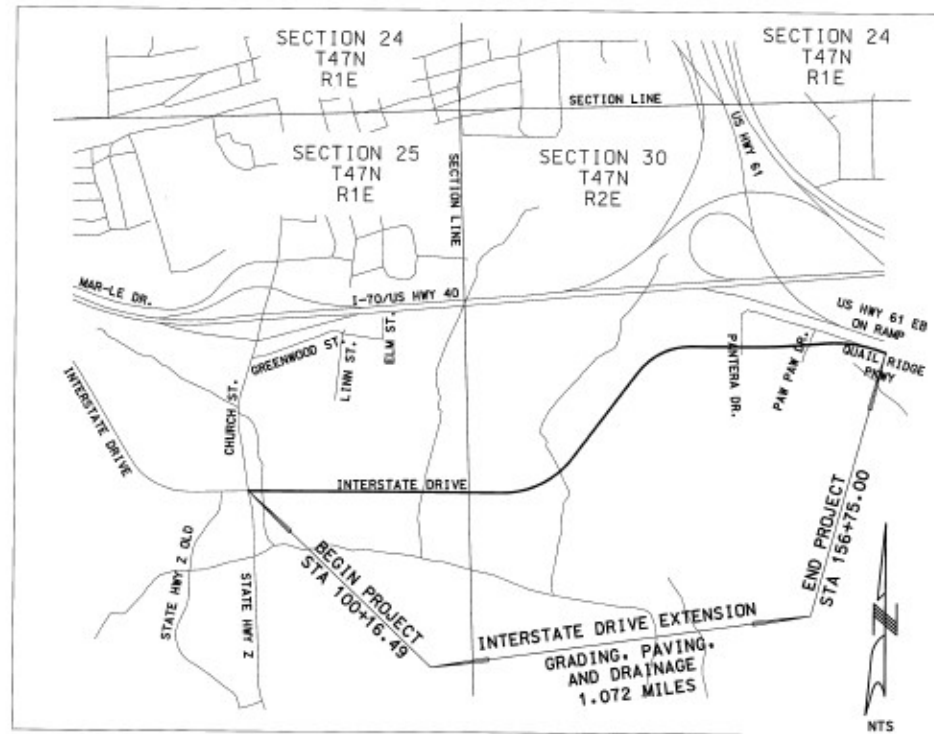

LOCATION MAP