

This road project paid in part through the  
St. Charles County ½ Cent Transportation Sales Tax.

## ELM STREET AND NEW TOWN BOULEVARD IMPROVEMENTS

### Project Location:

New Town Boulevard/Elm Street from Mueller Road to Elm Point Industrial Drive

### Project Description:

This project provided for improvements on New Town Boulevard and Elm Street. The project widened New Town Boulevard between Mueller Road and Fountain Lakes Industrial Drive to provide for an additional northbound lane. The project also widened Elm Street between Route 370 and Elm Point Industrial Drive to a new 5-lane roadway with new 4-foot-wide sidewalks on both sides of the road. The project provided for traffic signal modifications which included interconnection of the traffic signals and installation of video detection throughout the project corridor.

**Project Status:** Construction Completed

### Original Project Funding (Design, R/W & Construction):

TOTAL	County	Sponsor	Federal	Other
\$1,900,000	\$760,000	\$204,000	\$936,000	\$0

**FINAL COUNTY Contribution:** \$564,740

**Completion Year:** 2013

**Sponsor:** City of Saint Charles

**Contact:** Engineering Department

**Phone:** 636-949-3237

**Email:** [engineering.department@stcharlescitymo.gov](mailto:engineering.department@stcharlescitymo.gov)

**Website:** [City of Saint Charles Projects](#)

[St. Charles County Public Web Map Link](#)

Update: 11/17/2023

# NEW TOWN BOULEVARD WIDENING

FOR THE  
CITY OF ST. CHARLES,  
ST. CHARLES COUNTY, MISSOURI

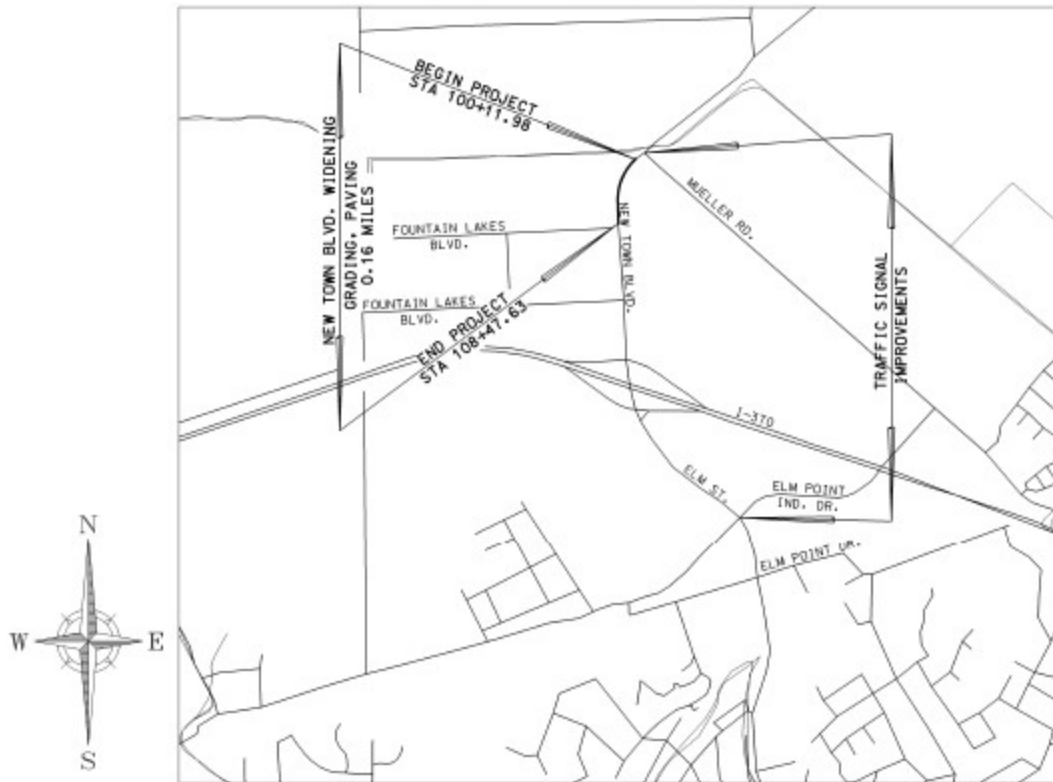

## VICINITY MAP

Scale: Not To Scale

## LENGTH OF PROJECT

New Town Boulevard: 836 Feet